

Aurora[®] Door Concepts Practicality in Design

Criterion Industries

Northcorp Industry Park
15 Corporate Place
Broadmeadows Victoria 3047

Telephone 03 9355 0700
Facsimile 03 9355 0777

sales@criterionindustries.com.au
www.criterionindustries.com.au



Aurora Door Concepts

This collection of commercial doors and related accessories has been designed to enhance our partition suites. The range has evolved due to insistence on the foundational principles; quality and durability.

The precise design combined with the stringent insistence on quality ensures long term performance of these products. A vast range of optional features are readily available, providing you with the assurance that your requirements will be fulfilled.

Take a look inside to discover 'practicality in design'.

- 1 Introduction
- 2 Aluminium Doors
- 4 Timber Doors
- 6 Optilite
- 8 Vent Flow
- 10 Chromis Entrance
- 12 Aurora Associated
- 14 Specifications



Aurora Aluminium Doors

Practicality in design.

The Aurora aluminium doors are manufactured to suit a vast variety of applications. Sections have been engineered and reinforced for high commercial use and premium operation. A customized machining service is available to install all types of furniture and accessories prior to delivery. Glazing pocket on the Aurora Aluminium Doors has been designed to incorporate glazing rubber. This ensures the door

can be pre-glazed prior to installation and provides a small consistent bead around the glass opening. Aurora Aluminium Doors can be incorporated into the Cascade sliding systems offering further design flexibility.

Features of Aluminium Doors

- Includes narrow and wide stiles;
- Machining and fitting of door furniture;
- Option of Rubber Glazing prior to delivery;
- Suits a vast range of acoustic and weather seals;
- Available in a range of powder coat and anodise finishes; and
- Glazing pocket accepts either rubber or silicone glazing options.

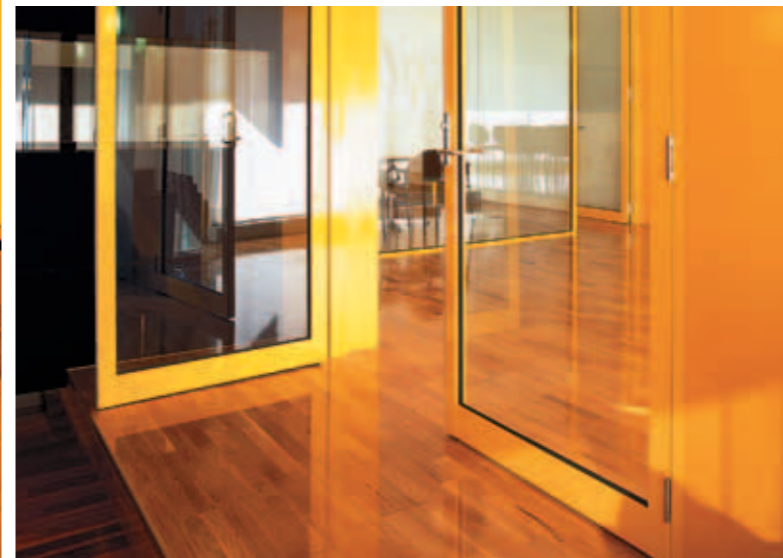



Aurora Timber Doors

Practicality in design.

The Aurora Timber Doors offer endless possibilities in size, construction and style. A diverse range of options is readily available including; vision panels, machining for hardware, specialised cladding and veneers.

Our stringent quality control procedures maintain a superior level of product integrity, essential in commercial and high end residential applications. The range includes sliding doors further complimenting the Cascade Sliding Systems.

Features of Timber Doors

- Quality commercial grade construction;
- Large range of stock doors;
- Exceptional turnaround time on custom sizes;
- Custom machining for associated hardware and seals;
- Viewing panels with a wide range of glass types;
- Variety of veneers available; and
- Fire rated doors.





Optilite®

Practicality in design.

The Optilite door vision panel is an innovative glazing concept. The pre-glazed feature of the Optilite eliminates the tedious process associated with traditional glazing, particularly in fitting of panels into an existing or prefinished door. The Optilite offers many advantages over alternative methods of glazing.

Available in a wide range of stock sizes, and manufactured with a variety of sizes, glass types and frame finishes. Optilites are an effective means of satisfying a broad range of safety requirements.

Features of Optilite

- Glazed in 6.38 clear laminate glass according to glazing code;
- Suit a range of door thicknesses – 32 to 48mm;
- Safety benefits;
- Custom sizes;
- Fully assembled pre-glazed unit; and

- Stocked in natural anodised finish and available in a wide range of sizes:
300 x 200
600 x 200
600 x 300
600 x 600
900 x 200
900 x 600
1700 x 200
- The above stock sizes are actual cut out sizes.





Vent Flow®

Practicality in design.

The aluminum Vent Flow air relief grilles are vital for air flow and air conditioning. The vents are supplied as a fully assembled unit ready for quick installation. The front and back frames are locked together by a strong metal clip which is fully concealed between the frames, eliminating unsightly fixings. The vents can be made to suit your specific size requirements and are available in a range of powder coat and anodise colours.

Features of Vent Flow

- Free air flow of 56%;
- Suits door thicknesses of 30- 48mm;
- Custom made sizes and colours;
- Suits aluminum and timber doors; and

- Stocked in natural anodised in a wide range of sizes:
600 x 150
600 x 200
600 x 250
600 x 300
600 x 450
600 x 600
The above stock sizes are actual cut out sizes.





Chromis® Entrance

Practicality in design.

The Chromis Entrance Handles are designed and developed to suit both industrial and residential use. Utilizing only commercial grade Stainless Steel ensures the Chromis Entrance will improve the outcome of any situation. A variety of styles are stocked and custom sizes can be fabricated in exceptional turnaround times.

Features of Chromis Entrance

- Commercial Grade Stainless Steel;
- Modern designs; and
- Variety of fixing options.





Aurora Associated

Practicality in design.

The Aurora Associated includes a vast array of door accessories to cover all your requirements. The range has been carefully designed in view of streamlining the installation process, whilst maintaining the architectural finesse. The selection includes; Lever Sets, Hinges, Door Stops and a variety of other premium products.

Features of Aurora Associated

- Large variety stocked;
- Designed and manufactured for commercial use; and
- Available in a range of sizes and finishes.



Aluminium Doors

Aluminium Door Suite

66mm Stiles

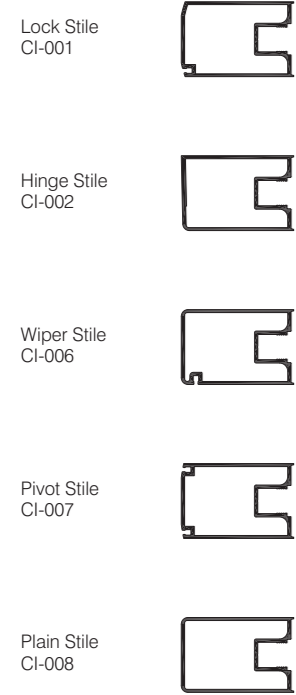

114mm Stiles

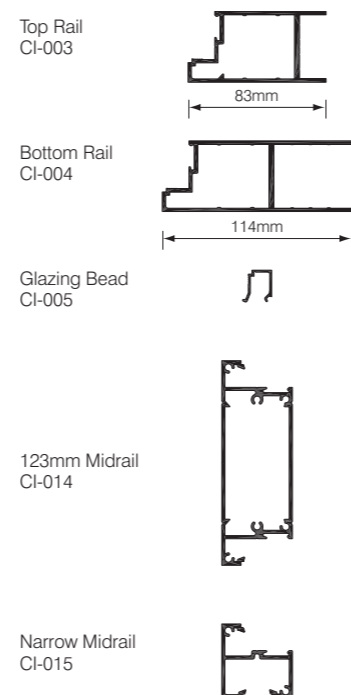
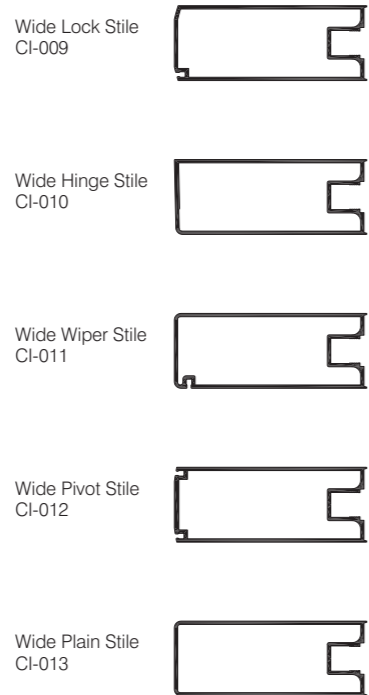

Optilite

Vision Panel

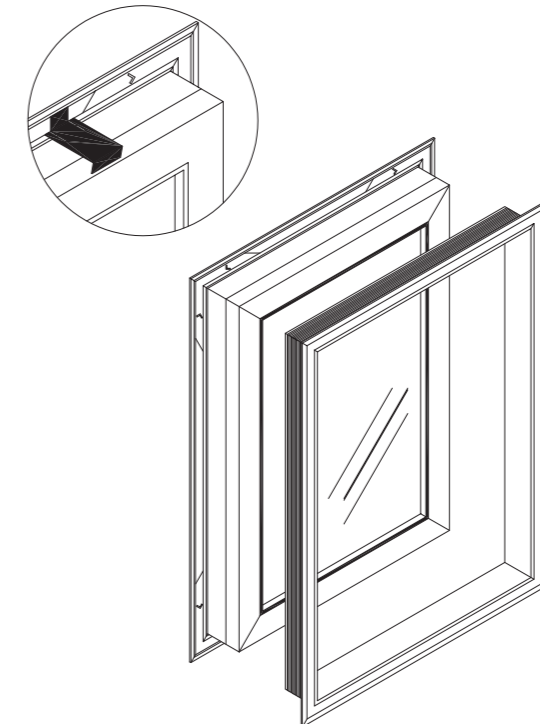

Timber Doors

MDF Skins Heavy Weight Flush Panel Door Construction

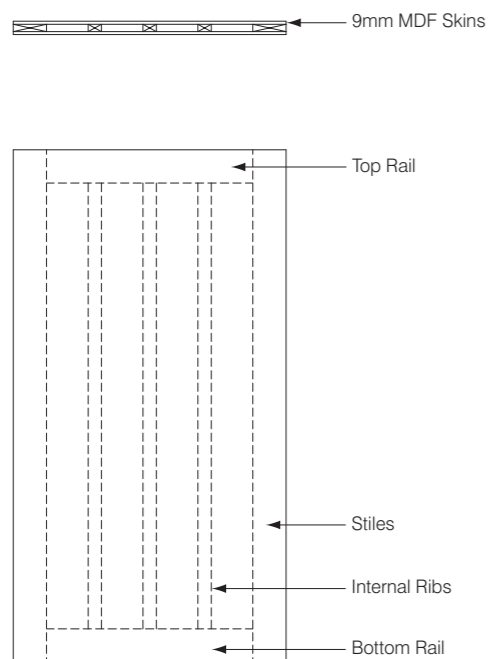

MDF Skins Light Weight Flush Panel Door Construction

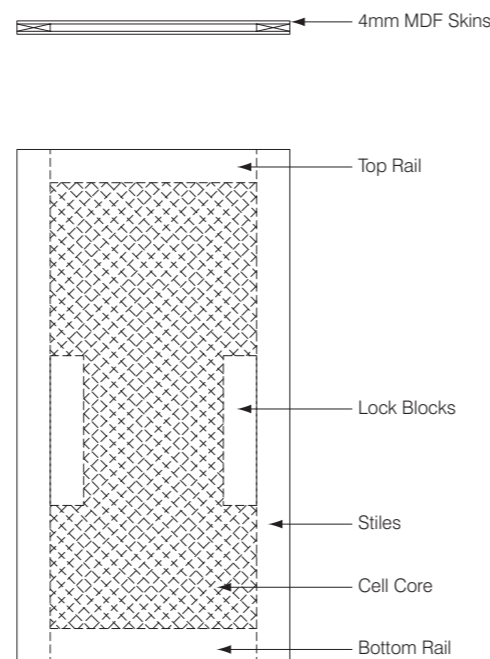

Vent Flow

Aluminium Door Vent

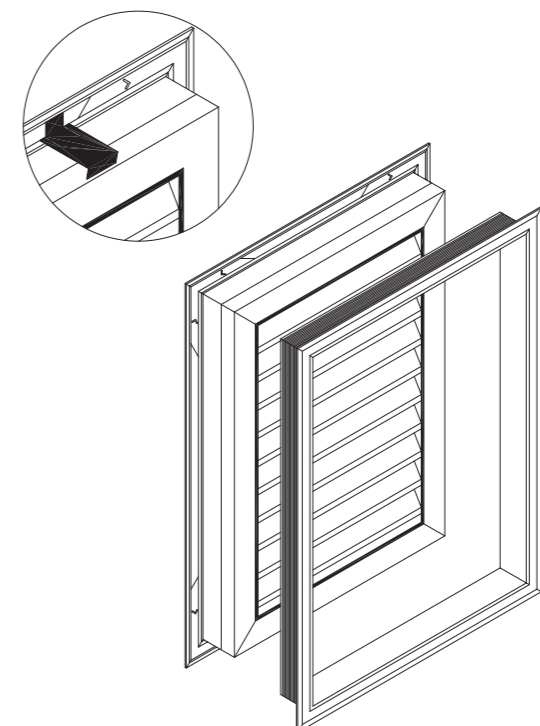

Chromis Entrance

Entrance Handles

Chromis 62

A	200	300	350	450	600	750	900		
B	25	25	25	25	25	-	-		
C	50	50	50	50	50	50	50		

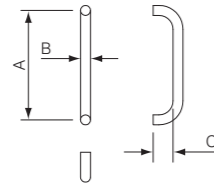

Chromis 66

Standoffs 25mm Diameter Straight

A	150	300	450	600	850	1100	1350	1600	1850
B	32	32	32	32	32	32	32	32	32
C	45	45	45	45	45	45	45	45	45
D	300	450	600	750	1000	1250	1500	1750	2000
E	25	25	25	25	25	25	25	25	25

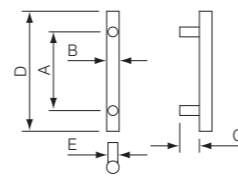

Chromis 63

A	300	350	450	600	750	900	1000	1250	1500
B	32	32	32	32	32	32	32	32	32
C	50	50	50	50	50	50	50	50	50
D	100	100	100	100	100	100	100	100	100

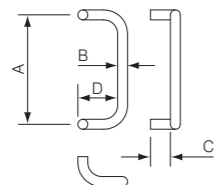

Chromis 67

Standoffs 25mm Square, 45° Mitred / Offset

A	150	300	450	600	850	1100	1350	1600	1850
B	32	32	32	32	32	32	32	32	32
C	45	45	45	45	45	45	45	45	45
D	300	450	600	750	1000	1250	1500	1750	2000
E	25	25	25	25	25	25	25	25	25

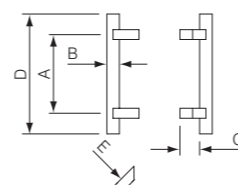

Chromis 64

Standoffs 25mm Square, Mitred / Offset

A	300	450	600	750	900	1200	1500		
B	25	25	25	25	25	25	25		
C	35	35	35	35	35	35	35		
D	325	475	625	775	925	1225	1525		
E	60	60	60	60	60	60	60		

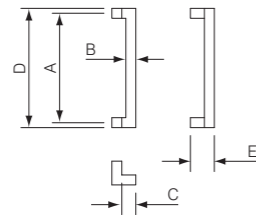

Chromis 68

Standoffs 25mm Diameter Straight

A	150	300	450	600	850	1100	1350	1600	1850
B	32	32	32	32	32	32	32	32	32
C	60	60	60	60	60	60	60	60	60
D	300	450	600	750	1000	1250	1500	1750	2000
E	25	25	25	25	25	25	25	25	25

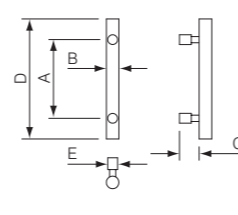

Chromis 65

Standoffs 50mm x 25mm Rectangular Straight

A	300	450	600	750	900	1000	1250	1500	1750	2000
B1	50	50	50	50	50	50	50	50	50	50
B2	25	25	25	25	25	25	25	25	25	25
C	35	35	35	35	35	35	35	35	35	35
D	325	475	625	775	925	1025	1275	1525	1775	2025

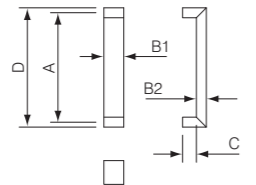

Chromis 69

Push / Pull Sets
300 x 65
CI-5230.7

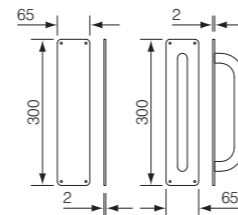

Chromis AL70

Chromis AL70
Flush Pull Handle
(Aluminium)

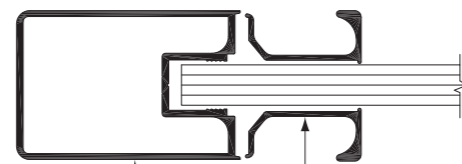
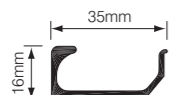

Aurora Aluminium
Stile

Chromis AL70
Flush Pull Handle
(Aluminium)

Aurora Associated

Hinges

Critech Interfold Hinge
CI-811010

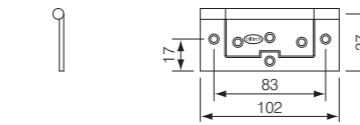

Aluminium Quick Fix Hinge
CI-811030

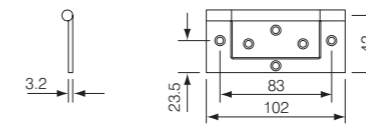

Stainless Steel Interfold Hinge
CI-811020

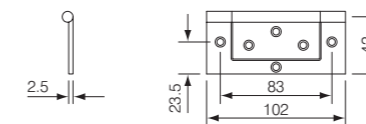

Solifer Hinge
LH (No. 1) CI-811040
RH (No. 2) CI-811041

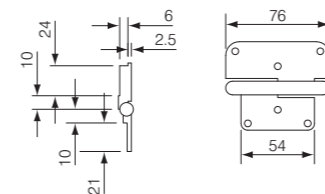

Stainless Steel Butt Hinge
(Ball Bearing) 100 x 75mm
CI-811050

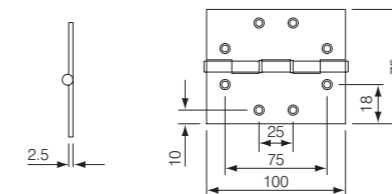

Roller Bolt

Roller Bolt
CI-801002

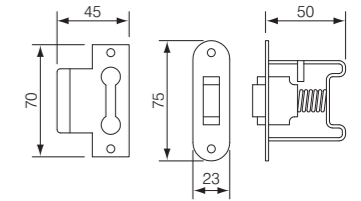

Panic Bolt

Concealed Fix Panic Bolt
300mm CI-8193
600mm CI-8196

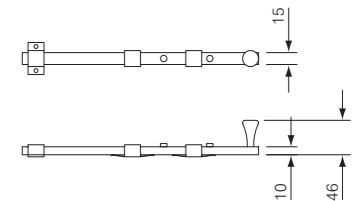

Visible Fix Panic Bolt
300mm CI-8183
600mm CI-8186

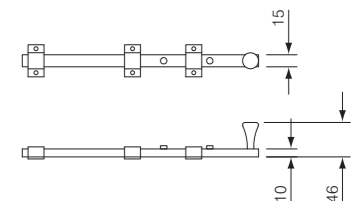

Flush Bolt

Aluminium Door Flush Bolt
300mm CI-8143
600mm CI-8146

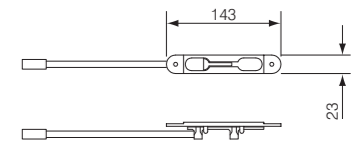

Flush Pulls

Flush Pull SSS
146 x 40
CI-816146

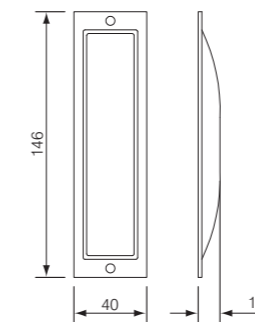

Flush Pull SSS
100 x 50
CI-816100

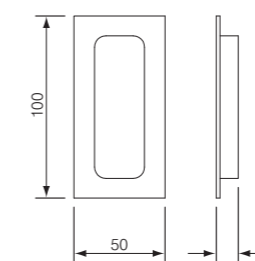

Door Stops

Floor Mounted
CI-250

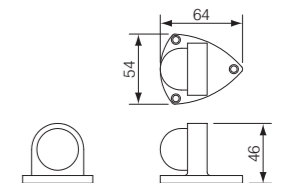

40mm Floor Mounted
CI-280

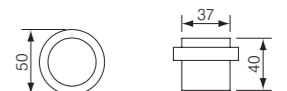

Nu Stop
CI-290



75mm Wall Mounted
CI-350



PVC Wall Mounted
Colours: Black, Grey, White
CI-813180

