

# Acacia Cavity System

Formulating  
character and  
distinction.

[www.criterionindustries.com.au](http://www.criterionindustries.com.au)

 **Criterion**





# Acacia Cavity

Acacia is a quality sliding cavity door system offering both style and value within residential and commercial spaces. Ideally suited for smaller light weight doors, the Arctic roller technology facilitates a smooth slide action with an optional soft close roller system.

Acacia cavity is made-to-order and is available in a single or bi-parting double unit.

Acacia is a reliable, high performance cavity door unit system that provides a quality cost-effective solution for any setting.

## WHY CHOOSE ACACIA?

- + Quick release roller hanger
- + Manufactured to suit 38mm Timber Doors
- + Manufactured to suit 44mm Aluminium Doors
- + Weight capacity up to 100kg (80kg Soft Close)

## ROLLER OPTIONS

- + Standard Roller - 100kg
- + Low Clearance Roller - 100kg
- + Soft Close Standard Roller - 40kg or 80kg
- + Soft Close Low Clearance Roller - 40kg or 80kg

## OPTIONAL EXTRAS

- |                             |   |
|-----------------------------|---|
| <b>Ezy-Reveal:</b>          | + 35mm Reveal Angle 3000mm  |
| <b>Rebated Closing Cap:</b> | + 118mm Rebated Closing Cap 3000mm<br>13mm Plaster / 92mm Stud / 13mm Plaster |
| <b>Steel Closing Cap:</b>   | + 112mm Ezy-Cap 3000mm<br>10mm Plaster / 92mm Stud / 10mm Plaster             |
|                             | + 118mm Ezy-Cap 3000mm<br>13mm Plaster / 92mm Stud / 13mm Plaster             |



ACACIA CAVITY - RESIDENTIAL

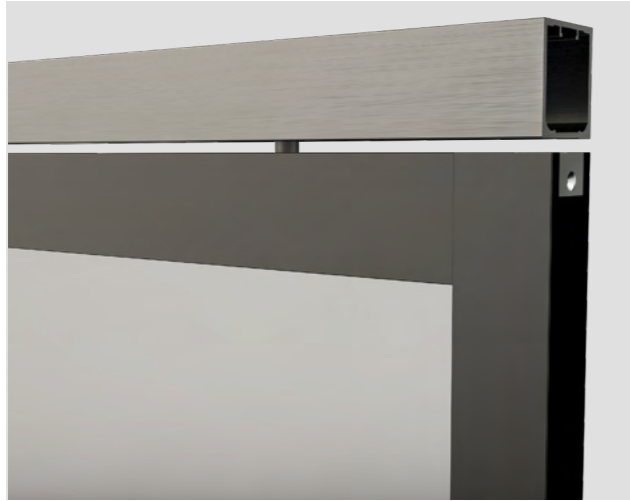

### Low Clearance

The low clearance roller allows a tiny 4mm clearance between the top of the door and the sliding track.

### Soft Close

The soft-close roller mechanism offers gentle door close and release.

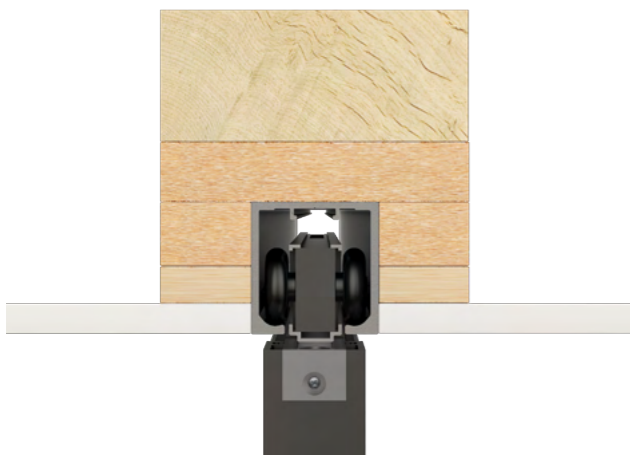
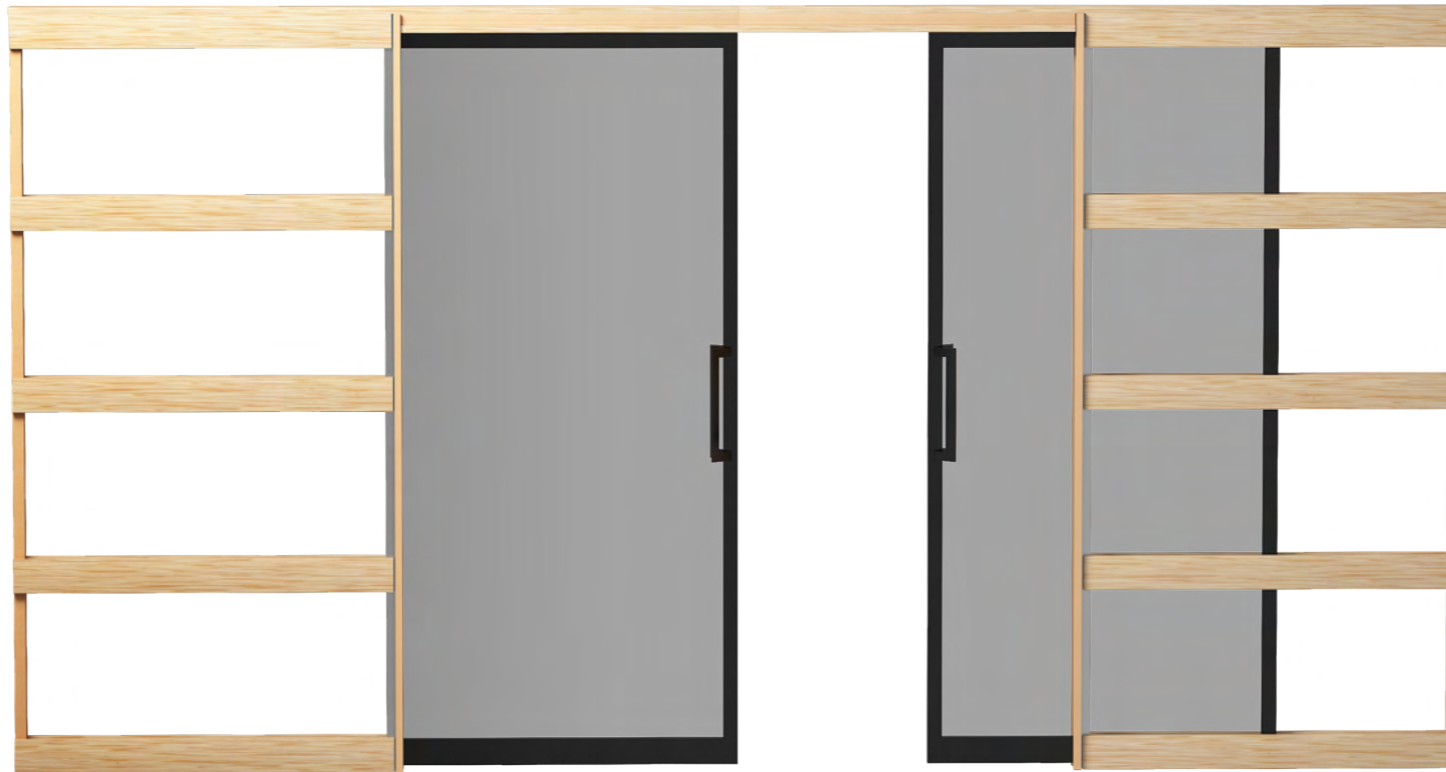

### Flush Head Detail

Designed to deliver a flush finish between the track and the ceiling, the flush head detail creates a smooth continuous flow from room to room.

### Bulk Head Detail

A square set finish around the sliding track where the door opening is lower than the ceiling height, providing a seamless and minimalistic finish.



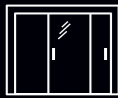

# ACACIA ELEVATIONS - TIMBER DOORS

### PELMET DETAIL

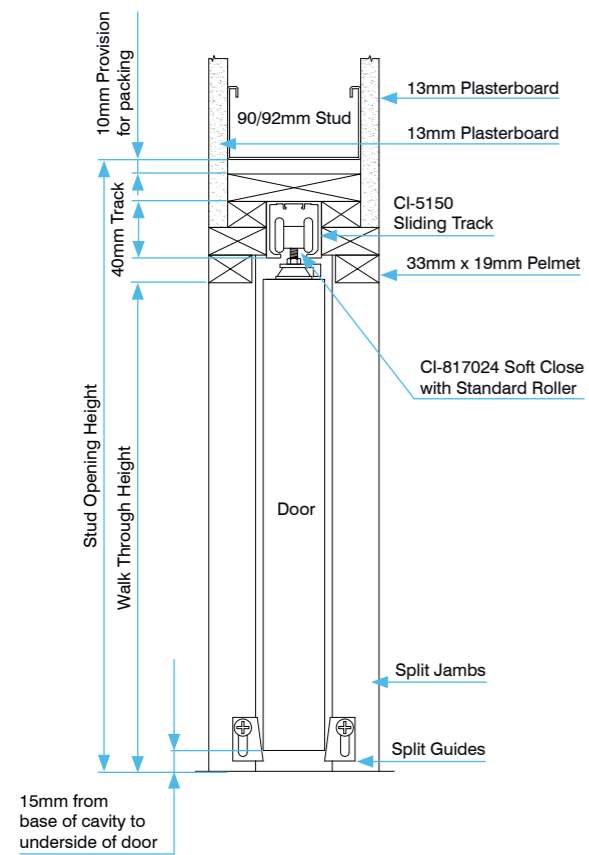

AC.01

### BULKHEAD DETAIL

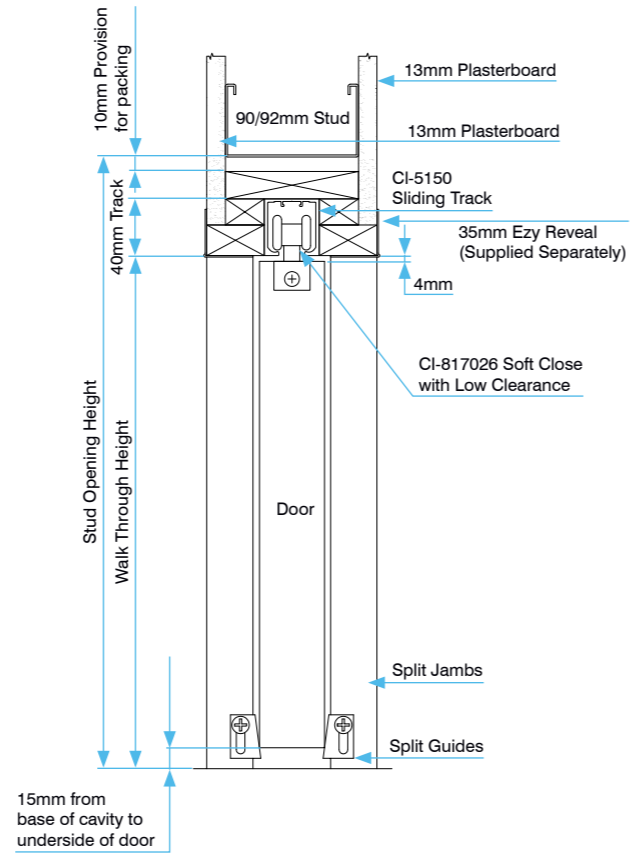

AC.02

### FLUSH HEAD DETAIL - 10MM PLASTER

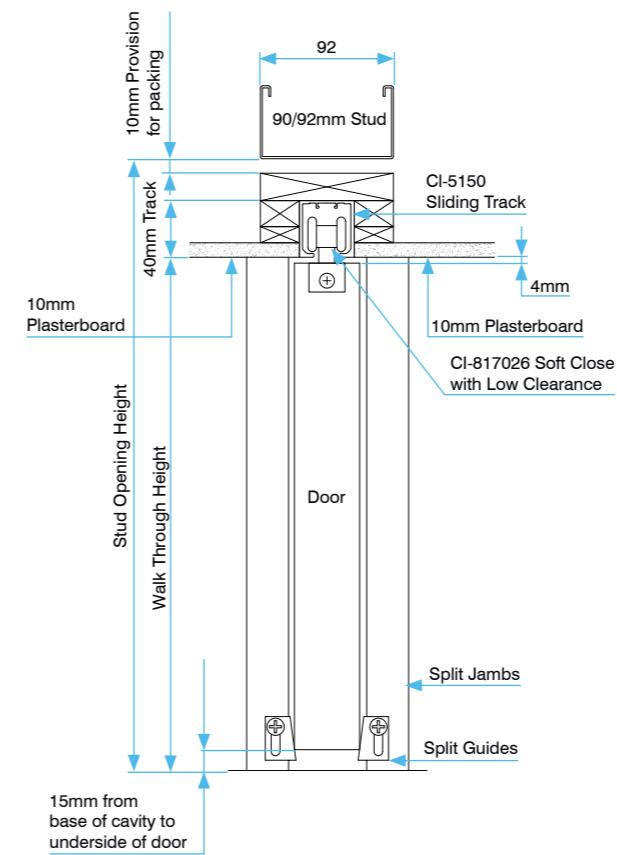

AC.03

### FLUSH HEAD DETAIL - 13MM PLASTER

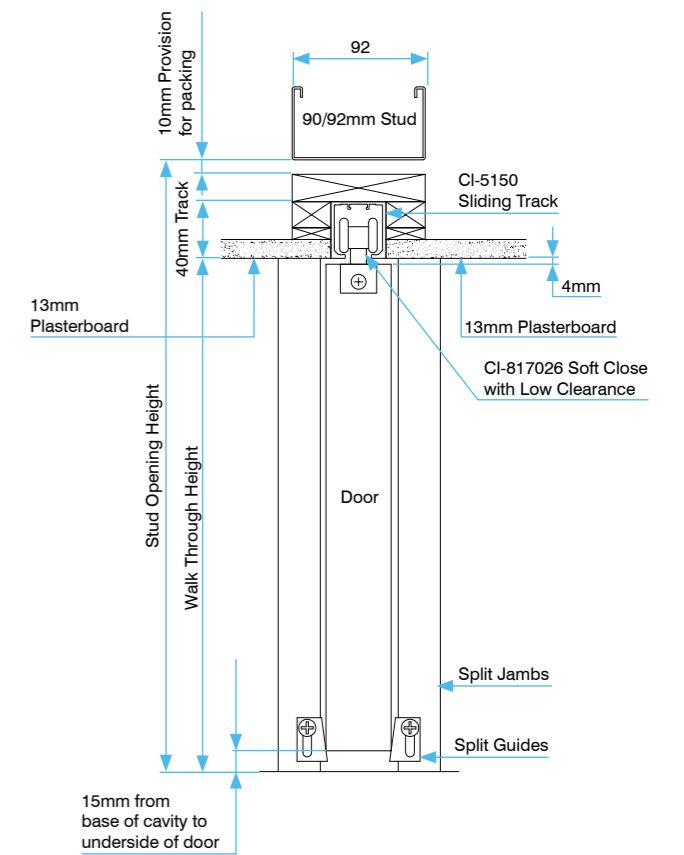

AC.04

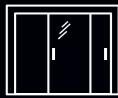

# ACACIA ELEVATIONS - ALUMINIUM DOORS

## PELMET DETAIL

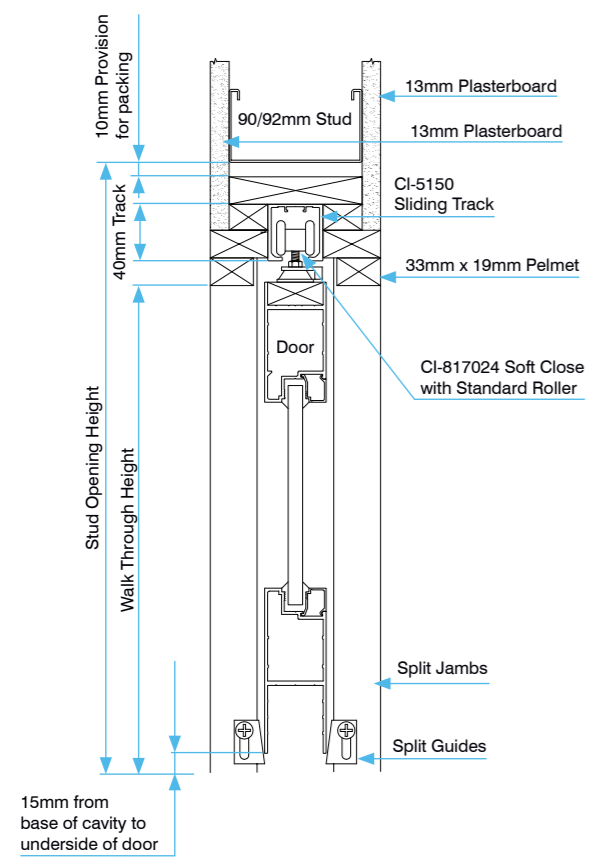

AC.05

## BULKHEAD DETAIL

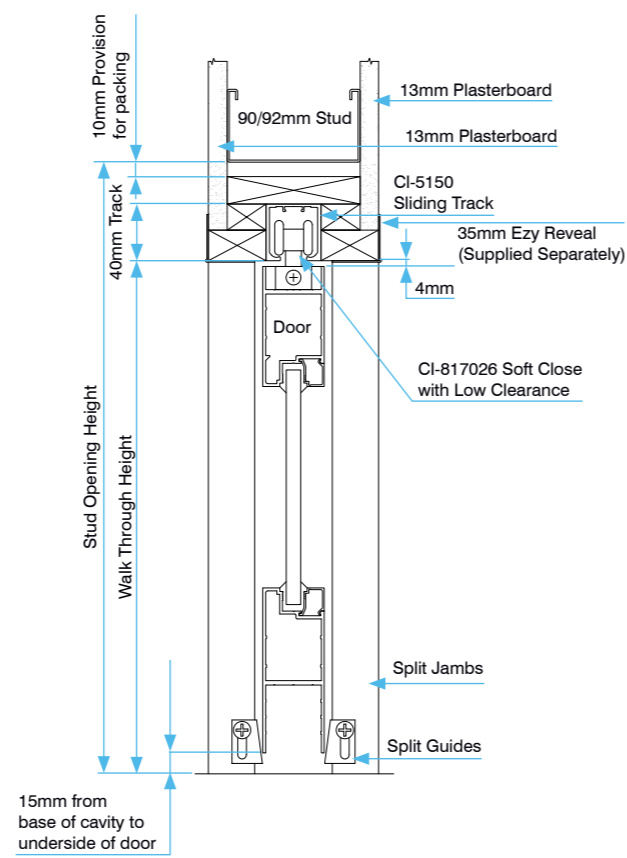

AC.06

## FLUSH HEAD DETAIL - 10MM PLASTER

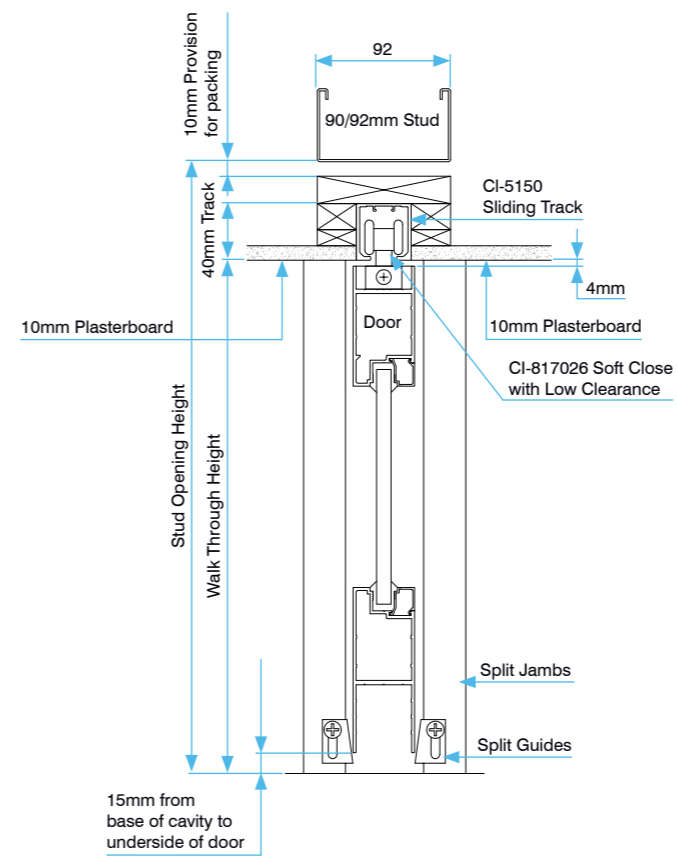

AC.07

## FLUSH HEAD DETAIL - 13MM PLASTER

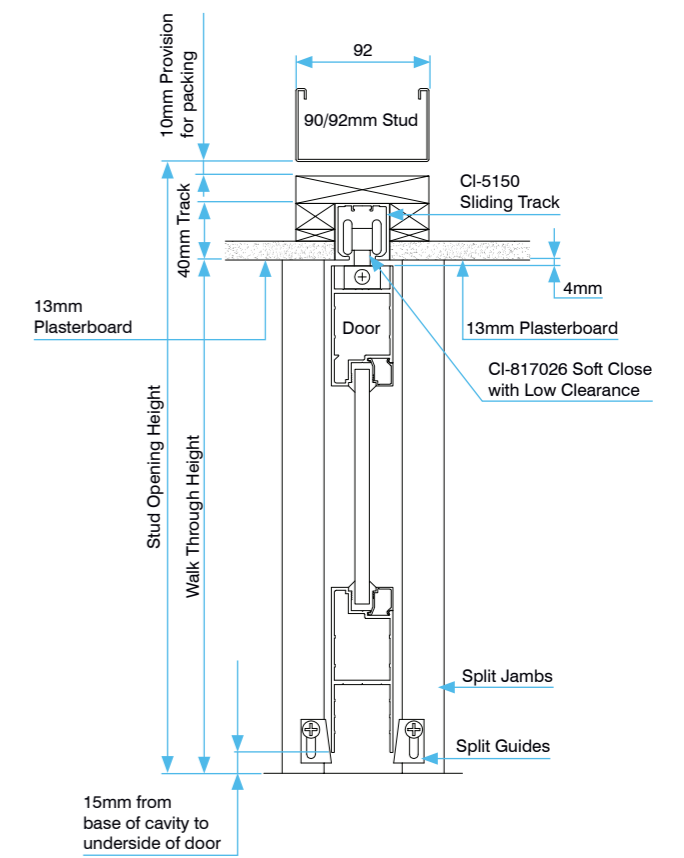

AC.08

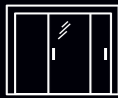

# ACACIA PLAN VIEWS

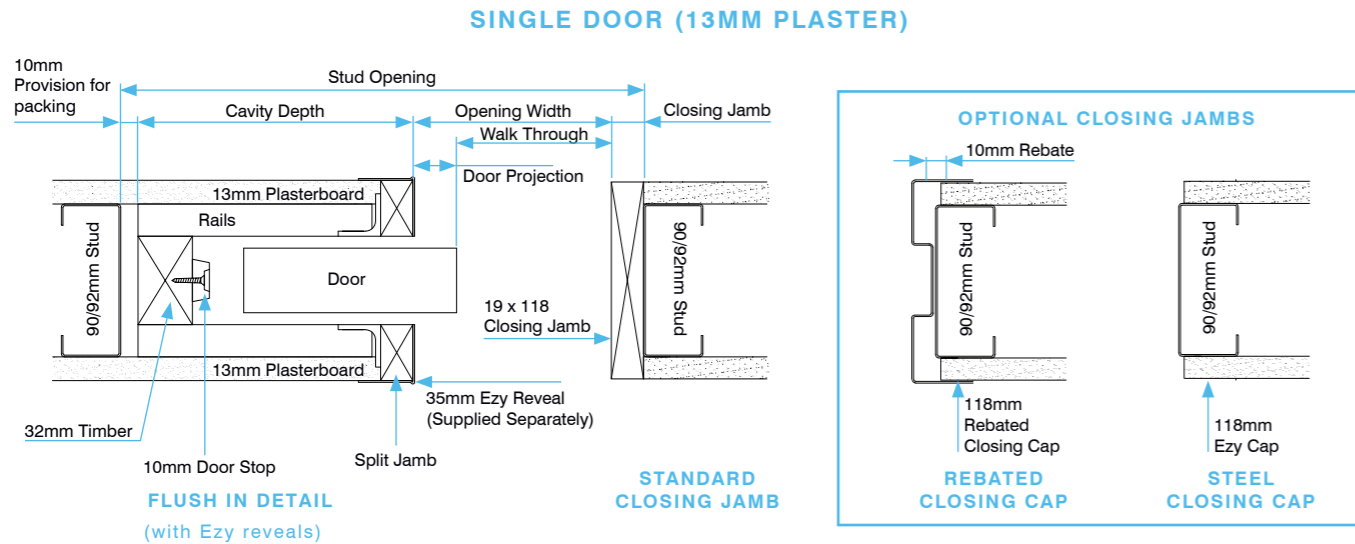

AC.08

\*Single & bipart can be made to suit Flush-in ezy reveal or architrave detail. Select as required when ordering.

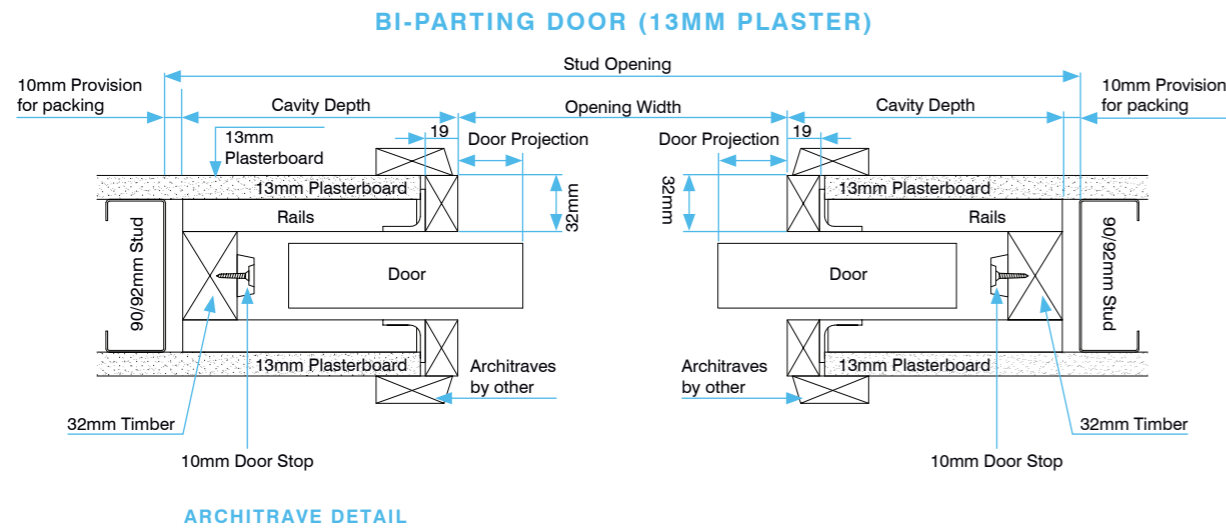

AC.09

# ACACIA FORMULAS

## SINGLE DOOR

PELMET DETAIL	FORMULA
<b>Door Sizes</b>	Door Height = Walk Through Height - 10mm
	Door Width = 30mm + Door Projection + Walk Through Width*
<b>Stud Openings</b>	Stud Height = Door Height + 97mm
	Stud Width = (Door Width x 2) - Door Projection + 40mm
BULKHEAD DETAIL	FORMULA
<b>Door Sizes</b>	Door Height = Walk Through - 19mm
	Door Width = 30mm + Door Projection + Walk Through Width*
<b>Stud Openings</b>	Stud Height = Door Height + 87mm
	Stud Width = (Door Width x 2) - Door Projection + 40mm
FLUSH HEAD DETAIL	FORMULA
<b>Door Sizes</b>	Door Height = Walk Through Height - 19mm
	Door Width = 30mm + Door Projection + Walk Through Width*
<b>Stud Openings</b>	Stud Height = Door Height + 87mm
	Stud Width = (Door Width x 2) - Door Projection + 40mm

\* Add 10mm when using Rebated Closing Jamb (771830).

## BI-PARTING DOOR

PELMET DETAIL	FORMULA
<b>Door Sizes</b>	Door Height = Walk Through Height - 10mm
	Door Width = (60mm + (Door Projection x 2) + Walk Through Width) / 2
<b>Stud Openings</b>	Stud Height = Door Height + 97mm
	Stud Width = ((Door Width x 2) - Door Projection + 20mm) x 2
BULKHEAD DETAIL	FORMULA
<b>Door Sizes</b>	Door Height = Walk Through - 19mm
	Door Width = (60mm + (Door Projection x 2) + Walk Through Width) / 2
<b>Stud Openings</b>	Stud Height = Door Height + 87mm
	Stud Width = ((Door Width x 2) - Door Projection + 20mm) x 2
FLUSH HEAD DETAIL	FORMULA
<b>Door Sizes</b>	Door Height = Walk Through Height - 19mm
	Door Width = (60mm + (Door Projection x 2) + Walk Through Width) / 2
<b>Stud Openings</b>	Stud Height = Door Height + 87mm
	Stud Width = ((Door Width x 2) - Door Projection + 20mm) x 2



# Formulating character and distinction.

Looking to discover more?

Contact us to book your  
free demonstration:

[www.criterionindustries.com.au](http://www.criterionindustries.com.au)



## **VIC**

23 Scanlon Drive  
Epping, VIC, 3076  
T: 03 9355 0700

[sales@criterionindustries.com.au](mailto:sales@criterionindustries.com.au)

## **NSW**

95 Victoria Street  
Smithfield, NSW, 2164  
T: 02 9355 0700

[sales.nsw@criterionindustries.com.au](mailto:sales.nsw@criterionindustries.com.au)

## **WA**

58 Tacoma Circuit  
Canning Vale WA 6155  
T: 08 9355 0700

[sales.wa@criterionindustries.com.au](mailto:sales.wa@criterionindustries.com.au)

## **QLD**

22 Holt Street  
Eagle Farm QLD 4009  
T: 07 3193 8990

[sales.qld@criterionindustries.com.au](mailto:sales.qld@criterionindustries.com.au)